



PYTHA LIBRARY CATALOGUE

1001 Standard Cabinet Internal Back

my **3D** shop



Image created with PYTHA 3D CAD. Copyright Pytha GmbH. Cabinetry in image does not represent actual library items.

Contents

- 1. Manufacturing Methods**
- 2. Purchase and Download Instructions**
- 3. Library Contents**
 - A. Fillers
 - B. Panels
 - C. Kickboards
 - D. Base Cabinets
 - E. Base Corner Cabinets
 - F. Base Drawer Cabinets
 - G. Tall Cabinets
 - H. Tall Corner Cabinets
 - I. Tall Combination Cabinets
 - J. Overhead Cabinets
 - K. Overhead Corner Cabinets
- 4. Terms and Conditions**



Manufacturing Methods

Our Method

Construction methods used when we build the library items are based on common manufacturing techniques.

Please check the sample construction drawing before making a purchase.

Library items are modifiable and you may be able to customize them to suit your construction methods.

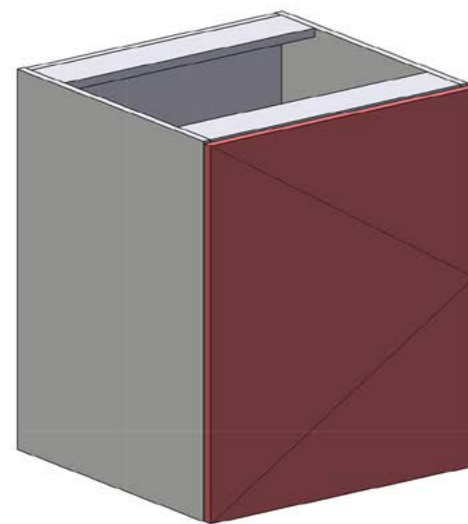

Section A-A

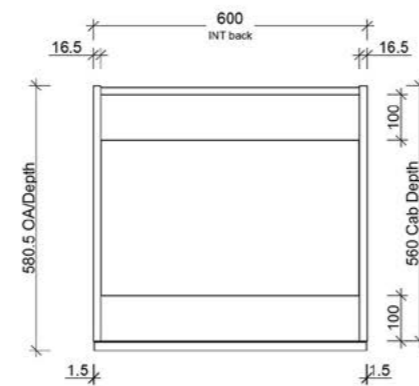

Section C-C

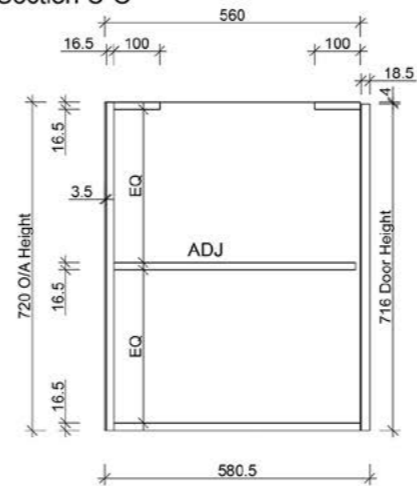

Instructions



Purchase

On receipt of your order and payment we will establish access for you to the online secure library within 48 hours.



Download

We will send you an electronic DropBox link to the online secure library. You will then have access to download and work with each of the items listed in this catalogue.

Library Contents



A. Fillers



D. Base Cabinets



G. Tall Cabinets



J. Overhead Cabinets

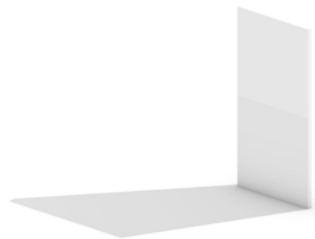

B. Panels

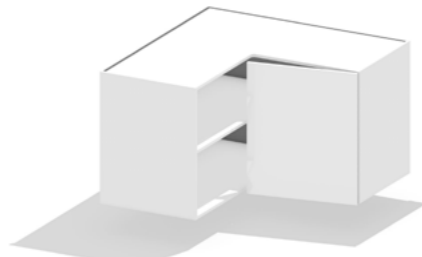

E. Base Corner Cabinets



H. Tall Corner Cabinets



K. Overhead Corner Cabinets

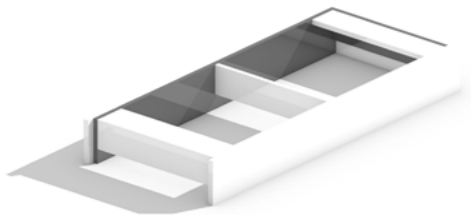

C. Kickboards

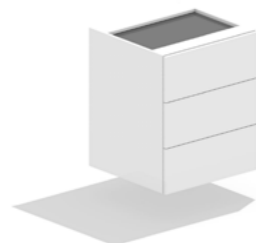

F. Base Drawer Cabinets

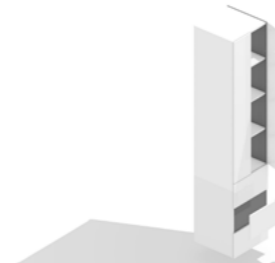

I. Tall Combination Cabinets

Library Contents

A. Fillers

Base Filler LH IB_BFLIB
Base Filler RH IB_BFRIB
OH Filler LH IB_OHFLIB
OH Filler RH IB_OHFRIB
OH Panel Filler LH IB_OHPFLIB
OH Panel Filler RH IB_OHPFRIB
Tall Filler LH IB_TFLIB
Tall Filler RH IB_TFRIB

B. Panels

Base End Panel To Floor IB_BEPFIB
Base End Panel To Kick IB_BEPKIB
OH End Panel IB_OHEPIB
Tall End Panel To Floor IB_TEPFIB
Tall End Panel To Kick IB_TEPKIB

C. Kickboards

Kick Between Walls IB_KBWIB
Kick Island Between Walls IB_KIBWIB
Kick Island Seen Both Ends IB_KISBEIB
Kick Island Seen Left IB_KISLIB
Kick Island Seen Right IB_KISRIB
Kick Island Standard IB_KISIB
Kick Island Wall Left Seen Right IB_KIWLSRIB
Kick Island Wall Right Seen Left IB_KIWRSLIB
Kick Seen Both Ends IB_KSBEIB
Kick Seen Left IB_KSLIB
Kick Seen Right IB_KSRIB
Kick Standard IB_KSIB
Kick Wall Left Seen Right IB_KWLSRIB
Kick Wall Right Seen Left IB_KWRSLIB

Library Contents

D. Base Cabinets

Base 1 Door LH IB_B1DLIB
Base 1 Door RH IB_B1DRIB
Base 2 Door IB_B2DIB
Base 2 Door Sink IB_B2DSIB
Base Open 16 IB_B016IB
Base Open 18 IB_B018IB
Base Open End LH 16 IB_BOEL16IB
Base Open End LH 18 IB_BOEL18IB
Base Open End RH 16 IB_BOER16IB
Base Open End RH 18 IB_BOER18IB
Base Wine 06 Bottles 16 IB_BW6B16IB
Base Wine 06 Bottles 18 IB_BW6B18IB
Base Wine 12 Bottles 16 IB_BW12B16IB
Base Wine 12 Bottles 18 IB_BW12B18IB
Base Wine 18 Bottles 16 IB_BW18B16IB
Base Wine 18 Bottles 18 IB_BW18B18IB

E. Base Corner Cabinets

Base Blind 1 Door LH IB_BB1DLIB
Base Blind 1 Door RH IB_BB1DRIB
Base Blind 2 Door LH IB_BB2DLIB
Base Blind 2 Door RH IB_BB2DRIB
Base Corner 1 Door LH IB_BC1DLIB
Base Corner 1 Door RH IB_BC1DRIB
Base Corner 2 Door LH IB_BC2DLIB
Base Corner 2 Door RH IB_BC2DRIB

F. Base Drawer Cabinets

Base 1 DRW IB_B1DRWIB
Base 2 EQ DRW IB_B2DRWIB
Base 3 DRW 122 IB_B3DRW122IB
Base 3 EQ DRW IB_B3DRWIB
Base 4 DRW 1112 IB_B4DRW1112IB

Library Contents

G. Tall Cabinets

Tall 1 Door LH Adj IB_T1DLAIB
Tall 1 Door LH IB_T1DLIB
Tall 1 Door RH Adj IB_T1DRAIB
Tall 1 Door RH IB_T1DRIB
Tall 1 Door Split LH IB_T1DSLIB
Tall 1 Door Split RH IB_T1DSRIB
Tall 2 Door Adj IB_T2DAIB
Tall 2 Door IB_T2DIB
Tall 2 Door Split IB_T2DSIB
Tall Broom 1 Door LH IB_TBR1DLIB
Tall Broom 1 Door RH IB_TBR1DRIB
Tall Broom 2 Door LH IB_TBR2DLIB
Tall Broom 2 Door RH IB_TBR2DRIB
Tall Open 16 IB_TO16IB
Tall Open 18 IB_TO18IB
Tall Open Adj 16 IB_TOA16IB
Tall Open Adj 18 IB_TOA18IB

Tall Open End LH 16 IB_TOEL16IB
Tall Open End LH 18 IB_TOEL18IB
Tall Open End RH 16 IB_TOER16IB
Tall Open End RH 18 IB_TOER18IB
Tall Pull Out Pantry IB_TPOPIB
Tall Wine 18 Bottles 16 IB_TW18B16IB
Tall Wine 18 Bottles 18 IB_TW18B18IB
Tall Wine 36 Bottles 16 IB_TW36B16IB
Tall Wine 36 Bottles 18 IB_TW36B18IB
Tall Wine 54 Bottles 16 IB_TW54B16IB
Tall Wine 54 Bottles 18 IB_TW54B18IB
Base 4 EQ DRW IB_B4DRWIB

Library Contents

H. Tall Corner Cabinets

Tall Blind 1 Door LH IB_TB1DLIB
Tall Blind 1 Door RH IB_TB1DRIB
Tall Blind 1 Door Split LH IB_TB1DSLIB
Tall Blind 1 Door Split RH IB_TB1DSRIB
Tall Blind 2 Door LH IB_TB2DLIB
Tall Blind 2 Door RH IB_TB2DRIB
Tall Blind 2 Door Split LH IB_TB2DSLIB
Tall Blind 2 Door Split RH IB_TB2DSRIB
Tall Corner 1 Door LH IB_TC1DLIB
Tall Corner 1 Door RH IB_TC1DRIB
Tall Corner 1 Door Split LH IB_TC1DSLIB
Tall Corner 1 Door Split RH IB_TC1DSRIB
Tall Corner 2 Door LH IB_TC2DLIB
Tall Corner 2 Door RH IB_TC2DRIB
Tall Corner 2 Door Split LH IB_TC2DSLIB
Tall Corner 2 Door Split RH IB_TC2DSRIB

I. Tall Combination Cabinets

Tall 1 Door LH 2 DRW IB_T1DL2DRWIB
Tall 1 Door LH 3 DRW 122 IB_T1DL3DRW122IB
Tall 1 Door LH 3 DRW IB_T1DL3DRWIB
Tall 1 Door LH 4 DRW 1112 IB_T1DL4DRW1112IB
Tall 1 Door LH 4 DRW IB_T1DL4DRWIB
Tall 1 Door RH 2 DRW IB_T1DR2DRWIB
Tall 1 Door RH 3 DRW 122 IB_T1DR3DRW122IB
Tall 1 Door RH 3 DRW IB_T1DR3DRWIB
Tall 1 Door RH 4 DRW 1112 IB_T1DR4DRW1112IB
Tall 1 Door RH 4 DRW IB_T1DR4DRWIB
Tall 2 Door 2 DRW IB_T2D2DRWIB
Tall 2 Door 3 DRW 122 IB_T2D3DRW122IB
Tall 2 Door 3 DRW IB_T2D3DRWIB
Tall 2 Door 4 DRW 1112 IB_T2D4DRW1112IB
Tall 2 Door 4 DRW IB_T2D4DRWIB

Library Contents

J. Overhead Cabinets

OH 1 Door LH IB_OH1DLIB
OH 1 Door RH IB_OH1DRIB
OH 2 Door IB_OH2DIB
OH Fridge 2 Door IB_OHF2DIB
OH Open 16 IB_OH016IB
OH Open 18 IB_OH018IB
OH Open Div 16 IB_OH0D16IB
OH Open Div 18 IB_OH0D18IB
OH Panel 1 Door LH IB_OHP1DLIB
OH Panel 1 Door RH IB_OHP1DRIB
OH Panel 2 Door IB_OHP2DIB
OH Panel Fridge 2 Door IB_OHPF2DIB

K. Overhead Corner Cabinets

OH Blind 1 Door LH IB_OHB1DLIB
OH Blind 1 Door RH IB_OHB1DRIB
OH Blind 2 Door LH IB_OHB2DLIB
OH Blind 2 Door RH IB_OHB2DRIB
OH Corner 1 Door LH IB_OHC1DLIB
OH Corner 1 Door RH IB_OHC1DRIB
OH Corner 2 Door LH IB_OHC2DLIB
OH Corner 2 Door RH IB_OHC2DRIB
OH Panel Blind 1 Door LH IB_OHPB1DLIB
OH Panel Blind 1 Door RH IB_OHPB1DRIB
OH Panel Blind 2 Door LH IB_OHPB2DLIB
OH Panel Blind 2 Door RH IB_OHPB2DRIB
OH Panel Corner 1 Door LH IB_OHPC1DLIB
OH Panel Corner 1 Door RH IB_OHPC1DRIB
OH Panel Corner 2 Door LH IB_OHPC2DLIB

Terms and Conditions

Conditions of use

By purchasing a Library product from My 3D Shop Pty Ltd you agree to these terms and conditions of use. My 3D Shop Pty Ltd may revise and update these terms and conditions at anytime and without notice.

Libraries in their entirety or otherwise can not be distributed, sold, assigned, transferred or otherwise redistributed either in our original format or as a part of a scene, animation or in any other format from which any original product, or any part of it can be separately exported, extracted, or decompiled into any redistributable form or format.

Library content can be modified in any way in order to conform to your needs, however any such modifications are still derivatives of the original and can not be sold or distributed as your own (whether to be sold separately or packaged/included with any other products/files).

Delivery policy

All products are delivered as access to an electronic file(s) on approval of your order. When your order is approved you will be redirected to a page with a download link. If for some reasons you didn't manage to download the item you can contact us for assistance.

All libraries will be delivered and maintained in the most recent version of PYTHA software. So libraries purchased under one version of the software, may not continue to be fully supported in future releases of the software. We will endeavor to maintain libraries for as long as they may be relevant.

Refund policy

Since My 3D Shop Pty Ltd is offering non-tangible, irrevocable goods we do not issue refunds once the order is accomplished and a link to access the file(s) is sent. As a customer you are responsible for understanding this upon purchasing any library item. We only make exceptions with this rule on the following reasons:

irreparable defects, missing textures, files, etc.: although all the products are thoroughly tested before release, unexpected errors may occur. In this case we may send you a download link with the missing or fixed files or make a refund;

product not-as-described: a request based on this reason is satisfied on a case by case basis in agreement of both parties concerned.

Requests for a refund are accepted within the period of 1 week after the order is placed. You should accompany this request with detailed and grounded reasons why you apply for a refund.

Copyright

All copyrights belong to My 3D Shop Pty Ltd, none of these rights are assigned or transferred to the end-user. All rights are protected by intellectual property laws, international treaty provisions and other applicable laws.



Terms and Conditions

Construction methods

Construction methods used when we build the library items are based on common Australian manufacturing techniques. Your construction methods may vary. Every customer should check the sample construction drawing accompanying each library before making a purchase. We have made every effort to display the products as accurately as possible.

Refunds will not be made for reason of differing construction methods. As a customer you are responsible for understanding this upon purchasing any library item.

Notice

My 3D Shop Pty Ltd makes no representation or warranty or condition of any kind, whether express or implied (either in fact or by operation of law) with respect to the product, including, without limitation, with respect to the sufficiency, accuracy or utilization of, or any information or opinion contained or reflected in, or produced through, any of the product. My 3D Shop Pty Ltd expressly disclaims all warranties or conditions of merchantability or fitness for a particular purpose. The product is provided "as is." The user assumes all risk of use. No officer,

director, employee, member, agent, or representative of My 3D Shop Pty Ltd is authorized to make any modification, extension, or addition to this limited warranty.

You the customer agrees that My 3D Shop Pty Ltd is not responsible, and shall have no liability to you or your business, with respect to any information, product or service offered by others who are linked to My 3D Shop Pty Ltd. My 3D Shop Pty Ltd shall not be liable for any damages allegedly sustained arising from use of the information in the PYTHA files.

Technical services

Implementation and trouble shooting support in the use of PYTHA Libraries is available for those customers on a valid PYTHA software technical services contract by an authorised technical support service provider. For customers not on a valid technical services contract, technical support may be delivered to you at an hourly rate. Please contact us for the latest out of contract hourly rates.



Visit our online store regularly for more products to turbo charge your workday.

WWW.MY3DSHOP.COM.AU

enquiries@my3dshop.com.au



Libraries



Online Training